

# Jular

---

50 years  
of passion for wood

---



1973–2023

# Jular

---

## Be the change you want to see!

The consciousness of global warming brought a new dynamic to the general use of wood, as the word was spread about its unique characteristic of carbon sink.

All of a sudden, wood emerged to the eyes of customers, architects, general contractors and public deciders as a powerful tool towards sustainability.

---

## Warehouses XXL timber structures



In the last decades of the 20th century, timber structures were seen as a very fashionable stravanza, resulting in very expensive building solutions.

Nowadays, wood structures are not only competitive with common steel and concrete structure alternatives, but also better performers when it comes to fire resistance, seismic behaviour and aesthetic arguments.

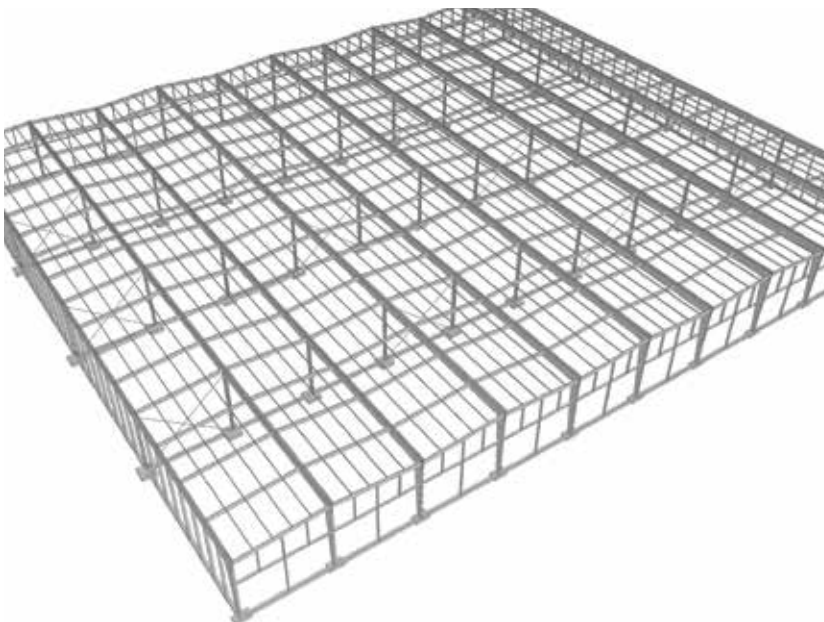



---

# Special timber structures

## Art and engineering

Wood has been assuming increasingly more importance in modern architecture.

Today, when architects and engineers design landmark buildings like bridges or government offices, schools, factories or warehouses, they look at timber to express a contemporary beauty which is nonetheless rooted in nature and a respect for the environment.

Its ease of work and reliability make it one of the most plastic building materials, allowing constant challenges to imagination.

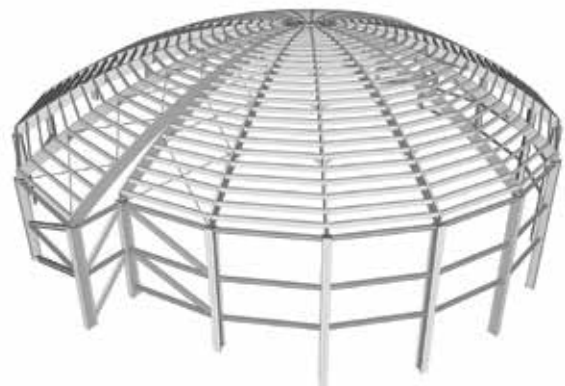
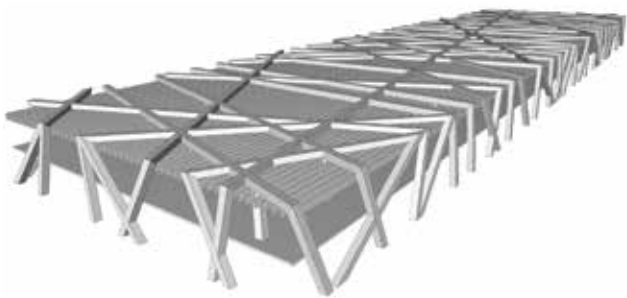

# Jular

## State of the art modular housing Sustainability + speed + design + quality

Treehouse modular houses have been developed from an innovative concept, which aims to bring together design, modularity, speed and sustainability.

**Treehouse is a high quality, tested and functional contemporary architectural solution, with great attention to detail.**

Planned production allows rigorous design, offering high performance, fulfilling all legal requirements and guaranteeing greater longevity for each treehouse. We offer a full in-house service, from consulting to assembly and final delivery.

Treehouse is eco-friendly given that it is made with ecological materials that come from certified and sustainable managed forests.

The concept behind Treehouse is modular: it grows module by module. Each one has a standard area of about 22 sqm. Even after finishing the assembly of one Treehouse, modules can still be added on both horizontally and vertically, to allow possible evolutions, with huge savings in costs and assembly time.

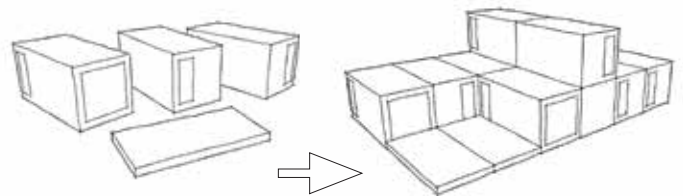



---

# treehouse

engineered by JULAR



---

# Sustainability:

## 10 reasons why we should use wood



Wood has been assuming increasingly more importance in modern architecture. Besides its natural properties of strength, beauty, durability, acoustic, thermal and fire resistance, wood was awarded one of the main roles in today's challenges: sustainability.

Wood was indeed recognized as the most sustainable raw material, as its use results in far less carbon dioxide emissions into the atmosphere than competing building products.

Here are 10 good reasons why we should prefer wood instead of other building materials:

- 1 \_\_\_\_\_  
Using wood products supports forests.
- 2 \_\_\_\_\_  
Wood stores carbon.
- 3 \_\_\_\_\_  
Wood is a renewable and versatile material.
- 4 \_\_\_\_\_  
Wood is a strong material.
- 5 \_\_\_\_\_  
Wood is beautiful.
- 6 \_\_\_\_\_  
Wood provides excellent sound and thermal insulation.
- 7 \_\_\_\_\_  
Wood is durable.
- 8 \_\_\_\_\_  
Wooden structures can have a high level of pre-fabrication.
- 9 \_\_\_\_\_  
Wood doesn't rust.
- 10 \_\_\_\_\_  
Wood behaves better under fire than steel.

---

# The company



Quality and sustainability are Jular's primary guiding principles.

Jular has been certified in Quality and Environmental Systems (ISO 9001:2015 and 14001:2015).

Present in the portuguese market since 1973, Jular has developed experience and know-how in wood-based products for the construction industry.



Jular's technical team offers broad experience in design and development of wooden structures. Designers and a motivated sales team can help to produce original solutions or develop existing projects.

Modern production premises and raw material warehouses totalling up to 28,000 sqm allow to provide a quick, efficient and high-quality response.

# Jular

[www.jular.pt](http://www.jular.pt)

---



Porto • Azambuja • Lisboa • Albufeira

